

CCM Drain 400

CCM Drain 400 performs a multi-facted role by providing protection for waterproofing systems and managing sub-surface water around building foundations. Soil back fill is retained by a filter fabric while allowing water to pass into the drainage core, providing hydrostatic relief. Collected water is then conveyed to a proper collection system. CCM Drain 400 consists of an impermeable polypropylene sheet cusped under heat and pressure to form a high flow dimpled drainage core. The core is then bonded to a layer of nonwoven filter fabric. The filter fabric retains soil or sand particles as well as freshly placed concrete or grout, allowing filtered water to pass into the drainage core. Applications include: foundation walls, retaining walls, planters, under slabs, bridge abutments.

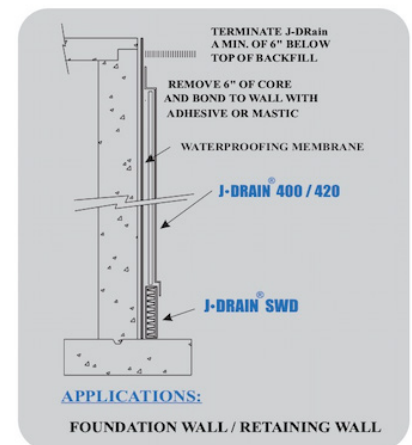
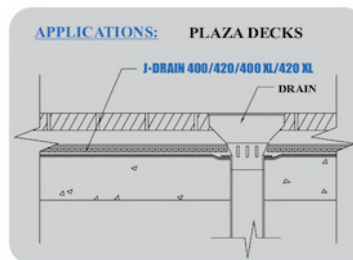
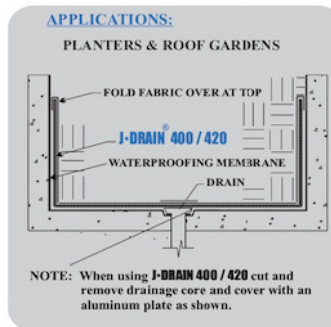

Specifications

| | |
|--|--|
| Product Code | CCM041 |
| Core | |
| Compressive Strength (ASTM D-1621) | 15,000 psf (718 kNm ²) |
| Thickness (ASTM D-1777) | .40 in (10.16 mm) |
| Flow (Hydraulic gradient =1) (ASTM D-4716) | 21 g/min/ft (260 L/min/m) |
| Fabric | |
| Flow (ASTM D-4491) | 140 gal/min/ft ² (5704 L/min/m ²) |
| CBR Puncture (ASTM D-6241) | 250 lbs (1.113 kN) |
| AOS (EOS) | 70 U.S. Sieve (.212 mm) |
| Grab Tensile (ASTM D-4632) | 100 lbs (.45 kN) |
| Dimensions | |
| Size | Weight (approx. lbs) |
| 4' x 50' | 39 |

Distributed by Colonial Construction Materials Inc.

1071 Merchants Lane Oilville, VA 23129

Ph. 800-436-6287

www.colonial-materials.com