

CCM Drain 150

CCM Drain 150 performs a multi-faceted role by providing protection for waterproofing systems and managing sub-surface water around building foundations. The product consists of a light duty impermeable low profile polymeric sheet cusped under heat and pressure to form a high flow dimpled drainage core. The core is then bonded with a layer of nonwoven filter fabric. The filter fabric retains soil or sand particles as well as freshly placed concrete or grout, allowing filtered water to pass into the drainage core. Collected water is then conveyed to a proper collection system. Applications include: basement foundations, retaining walls and planters.

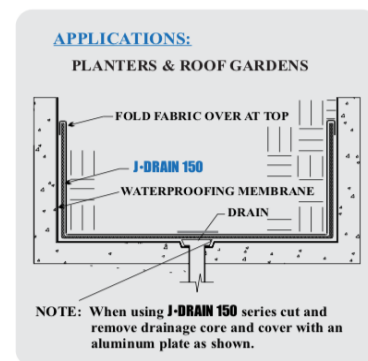
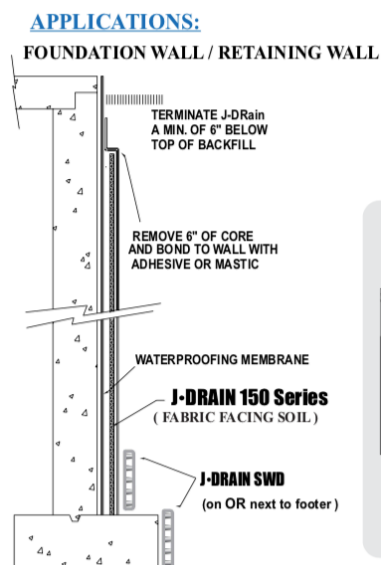

Specifications

Product Code	CCM415
Core	
Compressive Strength (ASTM D-1621)	5,200 psf (249 kNm ²)
Thickness (ASTM D-1777)	.31 in (7.87 mm)
Flow (Hydraulic gradient=1) (ASTM D-4716)	12.5 g/min/ft (155 L/min/m)
Fabric	
Flow (ASTM D-4491)	140 gal/min/ft ² (5704 l/min/m ²)
CBR Puncture (ASTM D-6241)	250 lbs (1.11 kN)
AOS (ASTM D-4751)	70 U.S. Sieve (.212 mm)
Grab Tensile (ASTM D-4632)	100 lbs (.45 kN)
U.V. Resistance (ASTM D-4355)	70% @ 500 hours
Dimensions	
Size	Weight (approx. lbs)
4' x 50'	35

Distributed by Colonial Construction Materials Inc.

1071 Merchants Lane Oilville, VA 23129

Ph. 800-436-6287

www.colonial-materials.com